

# BANCROFT ELEMENTARY SCHOOL

1755 Newton Street, N.W., Washington, DC



<b>INITIAL YEAR BUILT</b>	1924
<b>BUILDING AREA</b>	79,800 SF
<b>CURRENT PROGRAM CAPACITY</b>	527
<b>ENROLLMENT 2008</b>	460
<b>WARD</b>	1
<b>PROPOSED PROGRAM CAPACITY</b>	450



Site Plan

# BANCROFT ELEMENTARY SCHOOL

1755 Newton Street, N.W., Washington, DC

## PROPOSED PROGRAM PROFILE

<b>GRADE CONFIGURATION</b>	PK-5
<b>Fine Arts Program</b>	
<b>SQ. FT. (EXISTING)</b>	79,800 SF
<b>SQ. FT. (ADDITION)</b>	

TYPE	PROPOSED
Pre-School	2
Pre-Kindergarten	2
Kindergarten	3
1	3
2	3
3	3
4	3
5	3
6	
Gym	
Locker Rooms	
Gym-Cafeteria	
Cafetorium	
Gym-Cafetorium	
Gym-Auditorium	1

TYPE	PROPOSED
Auditorium	
Multi-Purpose	
Cafeteria	1
Kitchen Services	1
Special Education	2
Media Center	1
Administrative/Health	1
Computer Lab	1
OT/PT	1
Science Lab	
Art	1
Music	1
Teacher Workroom	1
Parent Resource	1

### Proposed Planning Profiles

The inventory of spaces listed here is intended to outline the program of educational and support spaces necessary to support the proposed program capacity. Individual educational specifications and facility programs will be developed with the School Improvement and School Planning / Design teams at the time of project initiation.

# BANCROFT ELEMENTARY SCHOOL

1755 Newton Street, N.W., Washington, DC

## CONDITION ASSESSMENT



Building System	2008 Rating
ADA Compliance	Poor
Conveying Systems	Poor
Electrical	Poor
Exterior Finish	Fair
HVAC	Fair
Interior Finish	Ok
Plumbing	Poor
Roof	Fair
Structure	Fair
Technology	Fair

### Condition Assessment

The body of information summarized below is based on a detailed facility condition assessment completed in 2006 and updated by visual observations conducted in 2007. Improvement initiatives completed by OPEFM in 2007 and 2008 are noted in red text in each section. An overall summary of work completed under various OPEFM programs is provided at the end of the condition assessment.

### Condition Scorecard

These ratings reflect the overall condition and level of replacement need for an entire system, in adherence with the **Facility Condition Index (FCI) System**, categorizing systems as "Good" (FCI < .25), "Fair" (FCI 0.25 – 0.50), "Poor" (FCI 0.51 – 0.85), or "Unsatisfactory" (FCI > .86).

### Comments:

<b>1 Conveying System</b>	There is no elevator, escalator, or lift present in the building.
<b>2 Electrical</b>	Lighting is in need of repair or upgrade to modern fixtures. Panel boards should be replaced. The fire alarm system is obsolete and not up to code standard. Inadequate receptacles in classrooms. <b>2007: Replacement of light ballast.</b>
<b>3 Exterior Finish</b>	Exterior doors are in fair condition and require minor repair work to prevent failure. Exterior brick and concrete appear to be in fair condition overall. Routine maintenance such as repainting and sealing are recommended.
<b>4 Structure</b>	The general structure of this facility is in fair condition. No specific, major deficiencies were observed as part of this assessment.
<b>5 HVAC</b>	The system as a whole is in fair condition. Condensate collection and return are in poor condition and need to be repaired or replaced. Radiators are in poor condition and should be removed as part of modernization or upgraded. Exhaust systems appear to be inadequate as well. <b>2007: Replacement of boiler circulating pumps, calibration of boiler burners, ventilator fan repairs, radiator control repairs and valve/steam trap repairs. 2008: Repairs to Boilers made. Installed 13 window A/C units.</b>
<b>6 Interior Finish</b>	Ceiling tiles and plaster finishes are in need of replacement. Vinyl flooring is beginning to wear and needs replacement in isolated areas. Some doors need to be replaced or repaired as well. <b>2007: The following targeted repair scope items have been completed: repair of skylights. Also flooring, plaster and painting repairs.</b>
<b>7 Plumbing</b>	Fixtures are in need of upgrading to meet code requirements. The waste system is in poor condition and needs to be replaced.
<b>8 Roof</b>	Drainage systems are downspouts. Damaged base flashing, needs to be repaired immediately. All drip edges at gutters are bent up. Deck type on tiles is wood decking. Sandstone coping absorbing water, recommend installing metal coping.

# BANCROFT ELEMENTARY SCHOOL

1755 Newton Street, N.W., Washington, DC

<b>9 ADA Compliance</b>	ADA items missing include ramp access, vertical conveying, stair handrails extensions, bathrooms or drinking fountains, and door offset at lever side. Exit doors were found to be padlocked
<b>10 Technology</b>	Visual inspection is a limited tool for technology assessments. Generally, the equipment observed appears to be in fair condition. Upgrades should include software, networking, and dedicated climate controlled spaces to house equipment.
<b>11 Grounds</b>	The grounds are generally in fair condition. Accommodations for ADA compliance should be made. Site drainage should be improved.

# BANCROFT ELEMENTARY SCHOOL

1755 Newton Street, N.W., Washington, DC

## RECENT HISTORY OF MODERNIZATION

### 2007 TARGETED REPAIRS

✓	Interior Finishes - Door Replacements/Door Hardware Repair
✓	Interior Finishes - Drywall & Ceiling Repairs
✓	Interior Finishes - Select Carpet Replacements/Flooring Repairs
✓	Interior Finishes - Painting/Plastering
✓	Plumbing Repairs - Restrooms/Fixtures & Flush Valves; Water Fountains
✓	Electrical Repairs - Lighting & Power
✓	Mechanical Repairs - AHU & Boiler Repairs, HVAC Filter Replacement
✓	Exterior Work & Building Envelope - Lighting, Site Work, Playground, etc.
✓	Other Work Orders

### 2008 STABILIZATIONS

✓	Heating Blitz - Boiler Repairs & Classroom Units
✓	Emergency Security Repair Work (Exterior Lighting Replacements)
<input type="checkbox"/>	AC Window Units Installations & Electrical Upgrades

◻ Planning
▼ Design
◆ Pre-Construction
◻ In Progress
✓ Completed

# BANCROFT ELEMENTARY SCHOOL

1755 Newton Street, N.W., Washington, DC

### Concept Plans

These floor plans represent planning concepts for proposed facility use, aligning the proposed program capacity, the proposed planning profiles, and the conceptual reconfiguration of the building. Each project is subject to a formal design process, incorporating input from the School Improvement team at the time of project initiation.

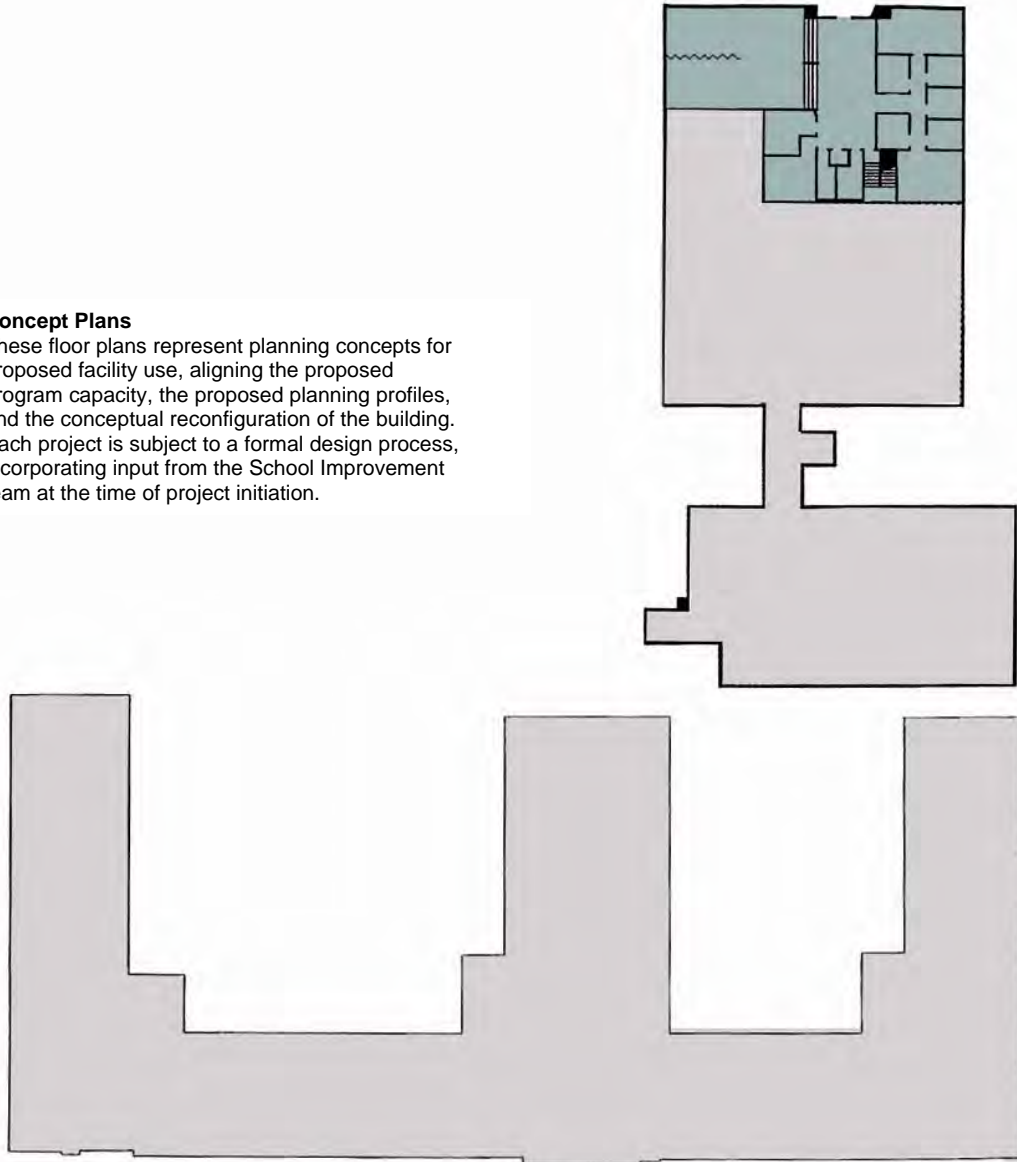

Lower Level

- |   |   |
|---|---|
| <span style="display: inline-block; width: 15px; height: 15px; background-color: #808080; border: 1px solid black;"></span> Administration/Health | <span style="display: inline-block; width: 15px; height: 15px; background-color: #D2691E; border: 1px solid black;"></span> Auditorium        |
| <span style="display: inline-block; width: 15px; height: 15px; background-color: #9ACD32; border: 1px solid black;"></span> Gymnasium/Cafeteria   | <span style="display: inline-block; width: 15px; height: 15px; background-color: #80CBC4; border: 1px solid black;"></span> Other             |
| <span style="display: inline-block; width: 15px; height: 15px; background-color: #66BB6A; border: 1px solid black;"></span> Classrooms            | <span style="display: inline-block; width: 15px; height: 15px; background-color: #FF9800; border: 1px solid black;"></span> Media Center      |
| <span style="display: inline-block; width: 15px; height: 15px; background-color: #BBDEFB; border: 1px solid black;"></span> Kindergarten          | <span style="display: inline-block; width: 15px; height: 15px; background-color: #A52A2A; border: 1px solid black;"></span> Computer Lab      |
| <span style="display: inline-block; width: 15px; height: 15px; background-color: #2196F3; border: 1px solid black;"></span> Pre-K/Pre-School      | <span style="display: inline-block; width: 15px; height: 15px; background-color: #4CAF50; border: 1px solid black;"></span> OT/PT             |
| <span style="display: inline-block; width: 15px; height: 15px; background-color: #C8E6C9; border: 1px solid black;"></span> Music/Art             | <span style="display: inline-block; width: 15px; height: 15px; background-color: #2196F3; border: 1px solid black;"></span> Special Education |
| <span style="display: inline-block; width: 15px; height: 15px; background-color: #4CAF50; border: 1px solid black;"></span> Science Lab           | <span style="display: inline-block; width: 15px; height: 15px; background-color: #9575CD; border: 1px solid black;"></span> Unassigned        |
| <span style="display: inline-block; width: 15px; height: 15px; background-color: #DCE775; border: 1px solid black;"></span> Lobby                 | <span style="display: inline-block; width: 15px; height: 15px; background-color: #9575CD; border: 1px solid black;"></span> Elevator Addition |

# BANCROFT ELEMENTARY SCHOOL

1755 Newton Street, N.W., Washington, DC

### Concept Plans

These floor plans represent planning concepts for proposed facility use, aligning the proposed program capacity, the proposed planning profiles, and the conceptual reconfiguration of the building. Each project is subject to a formal design process, incorporating input from the School Improvement team at the time of project initiation.

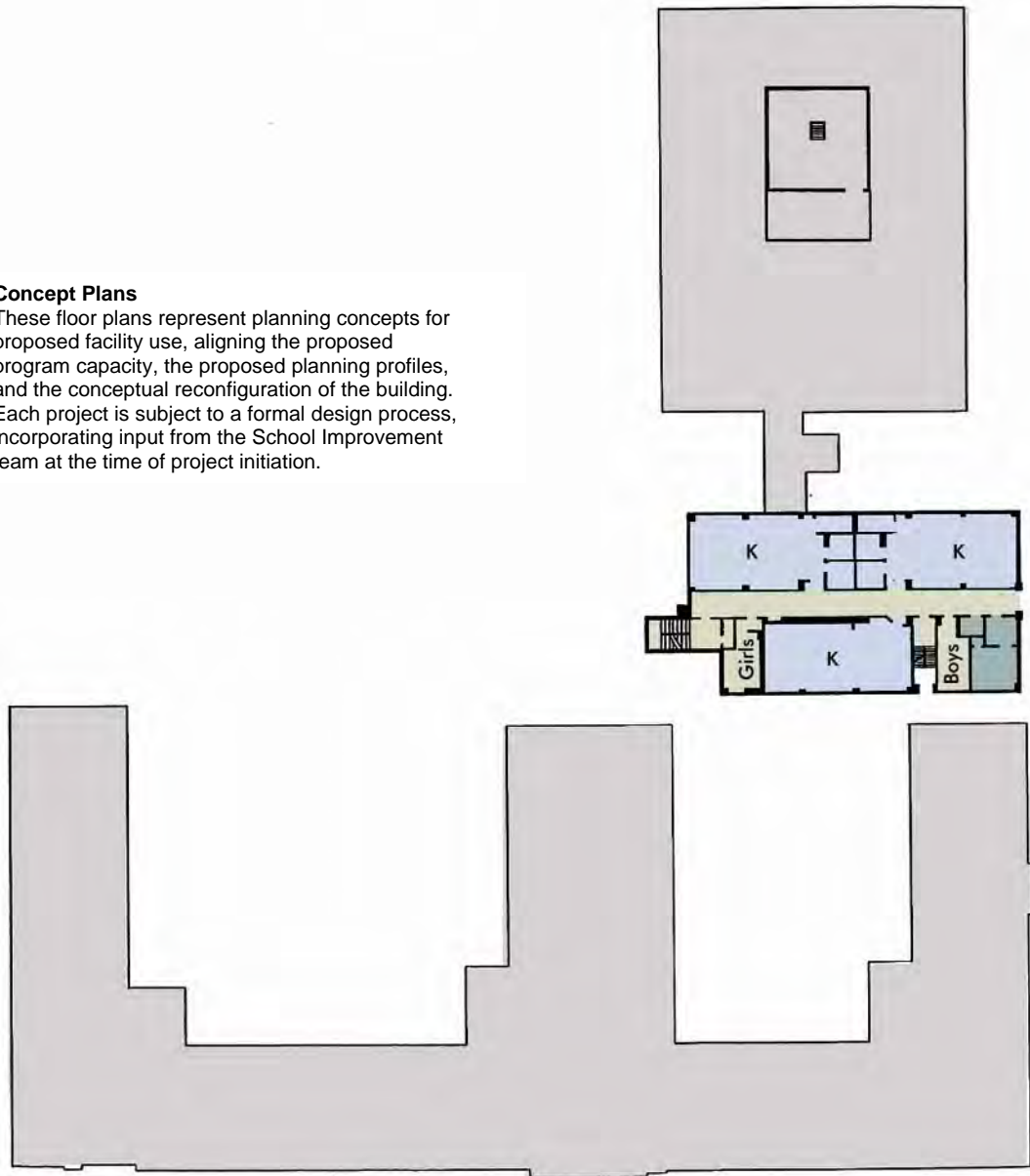

**Ground Floor**

- |   |   |
|---|---|
| <span style="display: inline-block; width: 15px; height: 15px; background-color: #808080; border: 1px solid black;"></span> Administration/Health | <span style="display: inline-block; width: 15px; height: 15px; background-color: #D2691E; border: 1px solid black;"></span> Auditorium        |
| <span style="display: inline-block; width: 15px; height: 15px; background-color: #9ACD32; border: 1px solid black;"></span> Gymnasium/Cafeteria   | <span style="display: inline-block; width: 15px; height: 15px; background-color: #ADD8E6; border: 1px solid black;"></span> Other             |
| <span style="display: inline-block; width: 15px; height: 15px; background-color: #6A5ACD; border: 1px solid black;"></span> Classrooms            | <span style="display: inline-block; width: 15px; height: 15px; background-color: #FF4500; border: 1px solid black;"></span> Media Center      |
| <span style="display: inline-block; width: 15px; height: 15px; background-color: #ADD8E6; border: 1px solid black;"></span> Kindergarten          | <span style="display: inline-block; width: 15px; height: 15px; background-color: #A0522D; border: 1px solid black;"></span> Computer Lab      |
| <span style="display: inline-block; width: 15px; height: 15px; background-color: #4169E1; border: 1px solid black;"></span> Pre-K/Pre-School      | <span style="display: inline-block; width: 15px; height: 15px; background-color: #3CB371; border: 1px solid black;"></span> OT/PT             |
| <span style="display: inline-block; width: 15px; height: 15px; background-color: #CD5C5C; border: 1px solid black;"></span> Music/Art             | <span style="display: inline-block; width: 15px; height: 15px; background-color: #4169E1; border: 1px solid black;"></span> Special Education |
| <span style="display: inline-block; width: 15px; height: 15px; background-color: #2E8B57; border: 1px solid black;"></span> Science Lab           | <span style="display: inline-block; width: 15px; height: 15px; background-color: #9370DB; border: 1px solid black;"></span> Unassigned        |
| <span style="display: inline-block; width: 15px; height: 15px; background-color: #D4C08E; border: 1px solid black;"></span> Lobby                 | <span style="display: inline-block; width: 15px; height: 15px; background-color: #9370DB; border: 1px solid black;"></span> Elevator Addition |

# BANCROFT ELEMENTARY SCHOOL

1755 Newton Street, N.W., Washington, DC

### Concept Plans

These floor plans represent planning concepts for proposed facility use, aligning the proposed program capacity, the proposed planning profiles, and the conceptual reconfiguration of the building. Each project is subject to a formal design process, incorporating input from the School Improvement team at the time of project initiation.

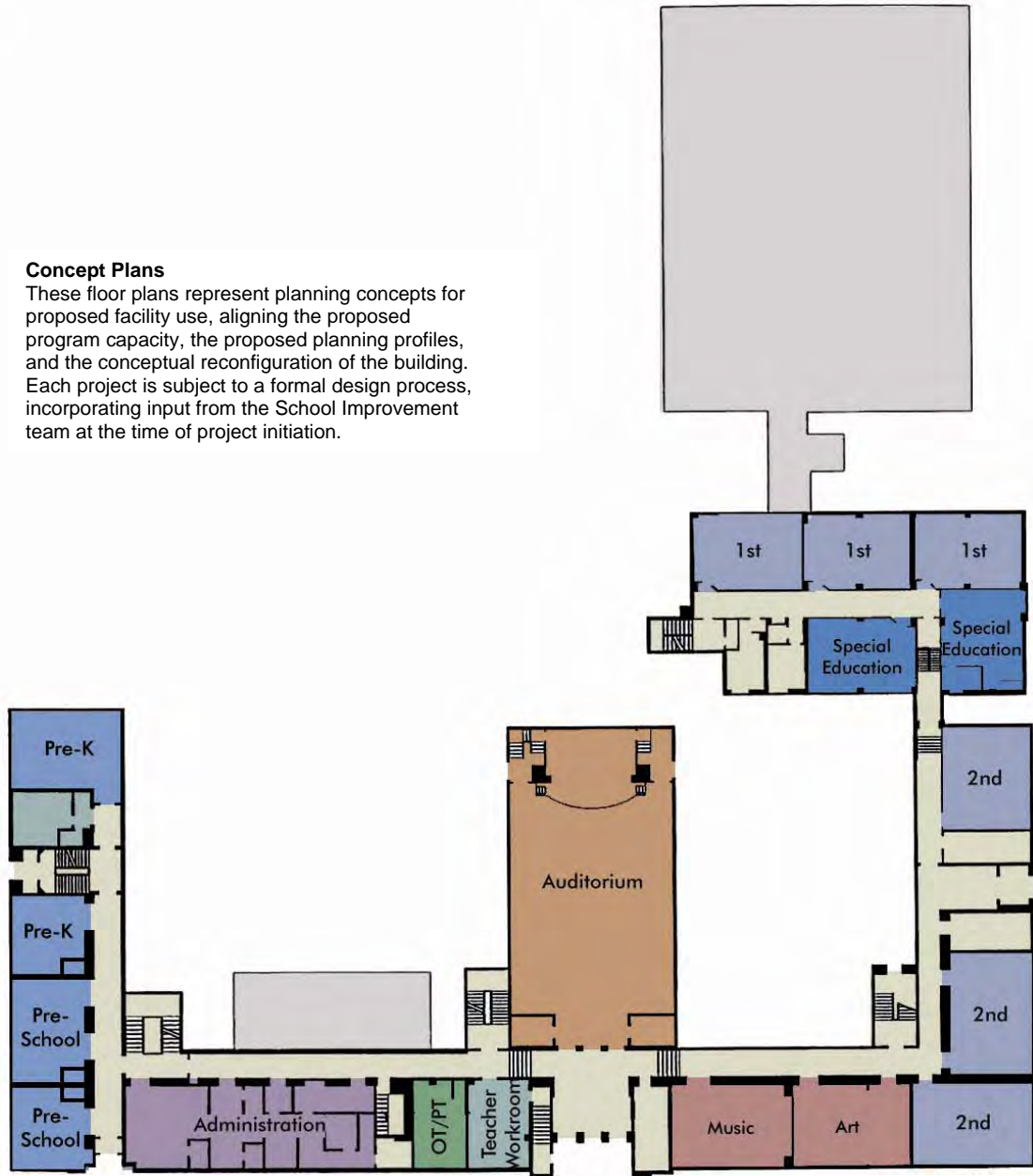

First Floor

- |   |   |
|---|---|
| <span style="display: inline-block; width: 15px; height: 15px; background-color: #808080; border: 1px solid black;"></span> Administration/Health | <span style="display: inline-block; width: 15px; height: 15px; background-color: #D2691E; border: 1px solid black;"></span> Auditorium        |
| <span style="display: inline-block; width: 15px; height: 15px; background-color: #90EE90; border: 1px solid black;"></span> Gymnasium/Cafeteria   | <span style="display: inline-block; width: 15px; height: 15px; background-color: #ADD8E6; border: 1px solid black;"></span> Other             |
| <span style="display: inline-block; width: 15px; height: 15px; background-color: #6A5ACD; border: 1px solid black;"></span> Classrooms            | <span style="display: inline-block; width: 15px; height: 15px; background-color: #FF8C00; border: 1px solid black;"></span> Media Center      |
| <span style="display: inline-block; width: 15px; height: 15px; background-color: #ADD8E6; border: 1px solid black;"></span> Kindergarten          | <span style="display: inline-block; width: 15px; height: 15px; background-color: #8B4513; border: 1px solid black;"></span> Computer Lab      |
| <span style="display: inline-block; width: 15px; height: 15px; background-color: #4169E1; border: 1px solid black;"></span> Pre-K/Pre-School      | <span style="display: inline-block; width: 15px; height: 15px; background-color: #3CB371; border: 1px solid black;"></span> OT/PT             |
| <span style="display: inline-block; width: 15px; height: 15px; background-color: #CD5C5C; border: 1px solid black;"></span> Music/Art             | <span style="display: inline-block; width: 15px; height: 15px; background-color: #4169E1; border: 1px solid black;"></span> Special Education |
| <span style="display: inline-block; width: 15px; height: 15px; background-color: #2E8B57; border: 1px solid black;"></span> Science Lab           | <span style="display: inline-block; width: 15px; height: 15px; background-color: #9370DB; border: 1px solid black;"></span> Unassigned        |
| <span style="display: inline-block; width: 15px; height: 15px; background-color: #D2B48C; border: 1px solid black;"></span> Lobby                 | <span style="display: inline-block; width: 15px; height: 15px; background-color: #9370DB; border: 1px solid black;"></span> Elevator Addition |



# BANCROFT ELEMENTARY SCHOOL

1755 Newton Street, N.W., Washington, DC

### Concept Plans

These floor plans represent planning concepts for proposed facility use, aligning the proposed program capacity, the proposed planning profiles, and the conceptual reconfiguration of the building. Each project is subject to a formal design process, incorporating input from the School Improvement team at the time of project initiation.

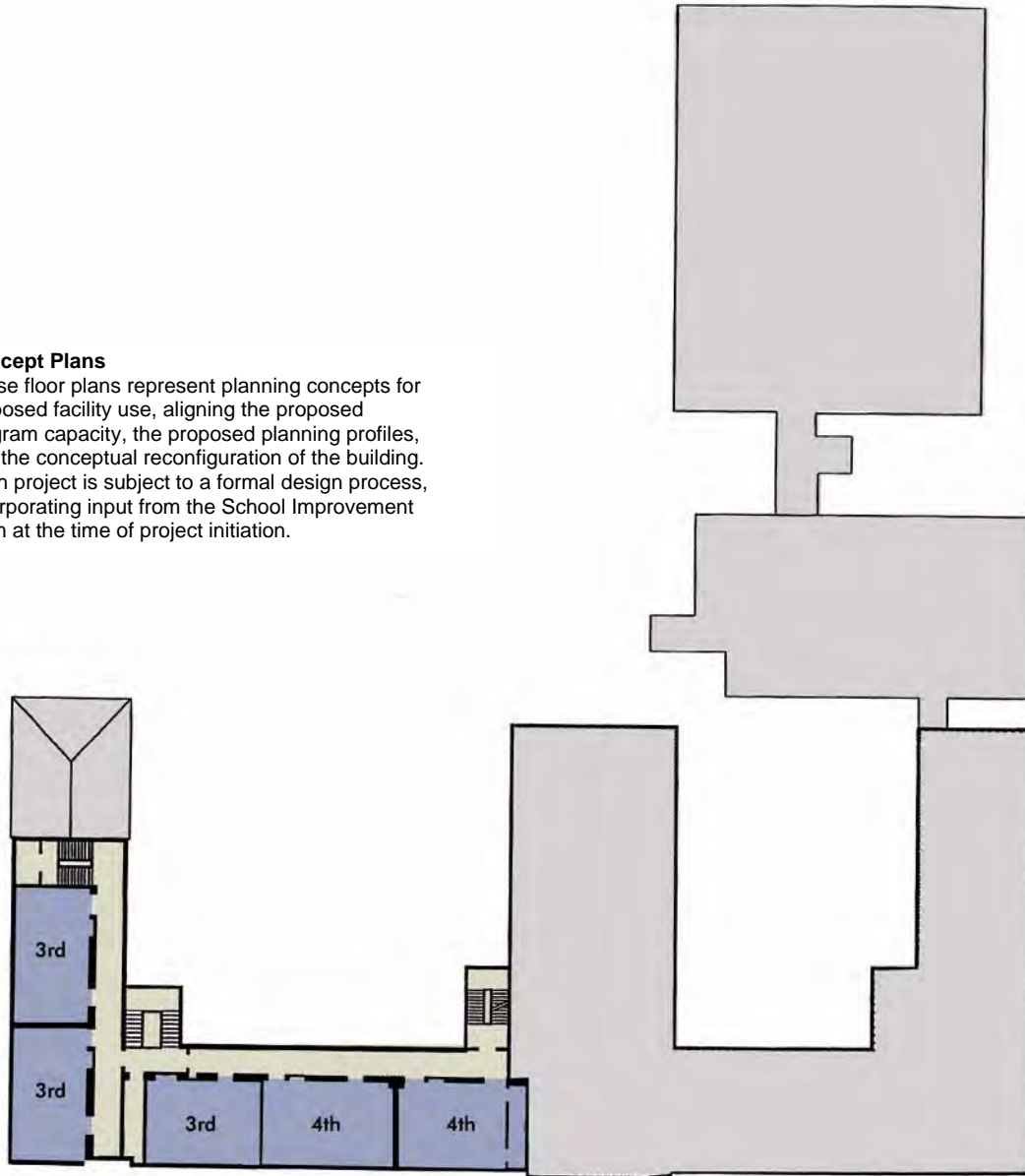

**Second Floor**

- |   |   |
|---|---|
| <span style="display: inline-block; width: 15px; height: 15px; background-color: #808080; border: 1px solid black;"></span> Administration/Health | <span style="display: inline-block; width: 15px; height: 15px; background-color: #FFD700; border: 1px solid black;"></span> Auditorium        |
| <span style="display: inline-block; width: 15px; height: 15px; background-color: #90EE90; border: 1px solid black;"></span> Gymnasium/Cafeteria   | <span style="display: inline-block; width: 15px; height: 15px; background-color: #ADD8E6; border: 1px solid black;"></span> Other             |
| <span style="display: inline-block; width: 15px; height: 15px; background-color: #666699; border: 1px solid black;"></span> Classrooms            | <span style="display: inline-block; width: 15px; height: 15px; background-color: #FF8C00; border: 1px solid black;"></span> Media Center      |
| <span style="display: inline-block; width: 15px; height: 15px; background-color: #ADD8E6; border: 1px solid black;"></span> Kindergarten          | <span style="display: inline-block; width: 15px; height: 15px; background-color: #A52A2A; border: 1px solid black;"></span> Computer Lab      |
| <span style="display: inline-block; width: 15px; height: 15px; background-color: #4169E1; border: 1px solid black;"></span> Pre-K/Pre-School      | <span style="display: inline-block; width: 15px; height: 15px; background-color: #3CB371; border: 1px solid black;"></span> OT/PT             |
| <span style="display: inline-block; width: 15px; height: 15px; background-color: #CD5C5C; border: 1px solid black;"></span> Music/Art             | <span style="display: inline-block; width: 15px; height: 15px; background-color: #4169E1; border: 1px solid black;"></span> Special Education |
| <span style="display: inline-block; width: 15px; height: 15px; background-color: #2E8B57; border: 1px solid black;"></span> Science Lab           | <span style="display: inline-block; width: 15px; height: 15px; background-color: #9370DB; border: 1px solid black;"></span> Unassigned        |
| <span style="display: inline-block; width: 15px; height: 15px; background-color: #D2B48C; border: 1px solid black;"></span> Lobby                 | <span style="display: inline-block; width: 15px; height: 15px; background-color: #9370DB; border: 1px solid black;"></span> Elevator Addition |

# BANCROFT ELEMENTARY SCHOOL

1755 Newton Street, N.W., Washington, DC

### Concept Plans

These floor plans represent planning concepts for proposed facility use, aligning the proposed program capacity, the proposed planning profiles, and the conceptual reconfiguration of the building. Each project is subject to a formal design process, incorporating input from the School Improvement team at the time of project initiation.

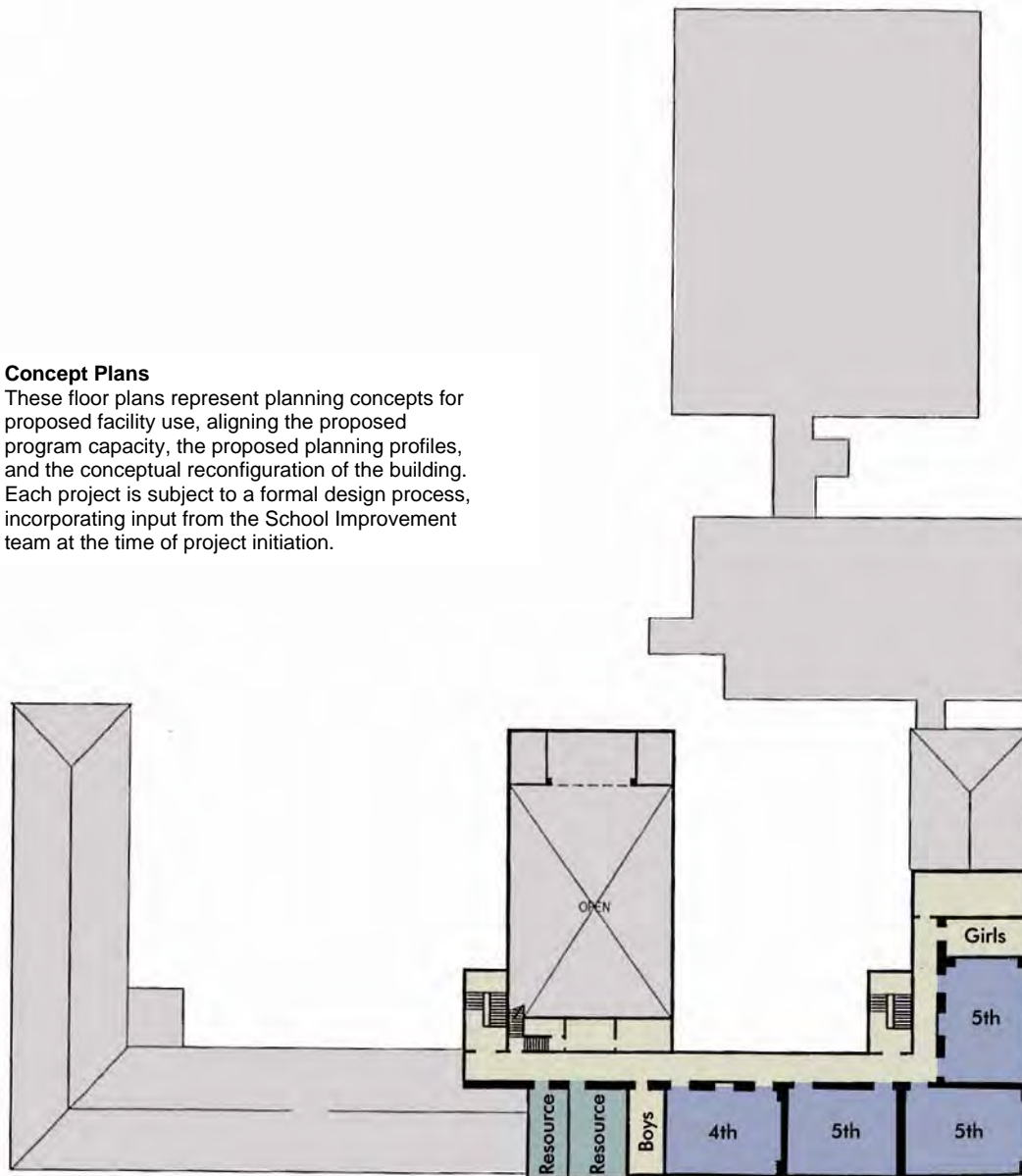

Third Floor

- |   |   |
|---|---|
| <span style="display: inline-block; width: 15px; height: 15px; background-color: #808080; border: 1px solid black;"></span> Administration/Health | <span style="display: inline-block; width: 15px; height: 15px; background-color: #FF8C00; border: 1px solid black;"></span> Auditorium        |
| <span style="display: inline-block; width: 15px; height: 15px; background-color: #90EE90; border: 1px solid black;"></span> Gymnasium/Cafeteria   | <span style="display: inline-block; width: 15px; height: 15px; background-color: #ADD8E6; border: 1px solid black;"></span> Other             |
| <span style="display: inline-block; width: 15px; height: 15px; background-color: #6A5ACD; border: 1px solid black;"></span> Classrooms            | <span style="display: inline-block; width: 15px; height: 15px; background-color: #FF4500; border: 1px solid black;"></span> Media Center      |
| <span style="display: inline-block; width: 15px; height: 15px; background-color: #ADD8E6; border: 1px solid black;"></span> Kindergarten          | <span style="display: inline-block; width: 15px; height: 15px; background-color: #A0522D; border: 1px solid black;"></span> Computer Lab      |
| <span style="display: inline-block; width: 15px; height: 15px; background-color: #4169E1; border: 1px solid black;"></span> Pre-K/Pre-School      | <span style="display: inline-block; width: 15px; height: 15px; background-color: #3CB371; border: 1px solid black;"></span> OT/PT             |
| <span style="display: inline-block; width: 15px; height: 15px; background-color: #CD5C5C; border: 1px solid black;"></span> Music/Art             | <span style="display: inline-block; width: 15px; height: 15px; background-color: #4169E1; border: 1px solid black;"></span> Special Education |
| <span style="display: inline-block; width: 15px; height: 15px; background-color: #2E8B57; border: 1px solid black;"></span> Science Lab           | <span style="display: inline-block; width: 15px; height: 15px; background-color: #9370DB; border: 1px solid black;"></span> Unassigned        |
| <span style="display: inline-block; width: 15px; height: 15px; background-color: #D2B48C; border: 1px solid black;"></span> Lobby                 | <span style="display: inline-block; width: 15px; height: 15px; background-color: #9370DB; border: 1px solid black;"></span> Elevator Addition |