

# KRAMER MIDDLE SCHOOL

1700 Q Street, S.E., Washington, DC



<b>INITIAL YEAR BUILT</b>	1943
<b>BUILDING AREA</b>	154,000 SF
<b>CURRENT PROGRAM CAPACITY</b>	655
<b>ENROLLMENT 2008</b>	346
<b>WARD</b>	8
<b>PROPOSED PROGRAM CAPACITY</b>	550



Site Plan

# KRAMER MIDDLE SCHOOL

1700 Q Street, S.E., Washington, DC

## PROPOSED PROGRAM PROFILE

<b>GRADE CONFIGURATION</b>	MS 6-8
----------------------------	--------

<b>SQ. FT. (EXISTING)</b>	154,000
<b>SQ. FT. (ADDITION)</b>	

TYPE	PROPOSED
6	7
7	7
8	7
Gym	1
Bleachers	
Locker Rooms	2
Gym-Cafeteria	
Cafetorium	
Gym-Cafetorium	
Gym-Auditorium	
Auditorium	1
Multipurpose	
Cafeteria	1

TYPE	PROPOSED
Kitchen Services	1
Special Education	6
Media Center	1
Administrative/Health Suite	1
Computer Lab	2
Art	2
OT/PT	1
Science Lab	3
Music	2
Teacher Workroom	1
Parent Resource	1

### Proposed Planning Profiles

The inventory of spaces listed here is intended to outline the program of educational and support spaces necessary to support the proposed program capacity. Individual educational specifications and facility programs will be developed with the School Improvement and School Planning / Design teams at the time of project initiation.

# KRAMER MIDDLE SCHOOL

1700 Q Street, S.E., Washington, DC

## CONDITION ASSESSMENT



<i>Building System</i>	<i>2008 Rating</i>
ADA Compliance	
Conveying Systems	
Electrical	
Exterior Finish	
HVAC	
Interior Finish	
Plumbing	
Roof	
Structure	
Technology	

**Condition Assessment**  
 The body of information summarized below is based on a detailed facility condition assessment completed in 2006 and updated by visual observations conducted in 2007. Improvement initiatives completed by OPEFM in 2007 and 2008 are noted in red text in each section. An overall summary of work completed under various OPEFM programs is provided at the end of the condition assessment.

**Condition Scorecard**  
 These ratings reflect the overall condition and level of replacement need for an entire system, in adherence with the **Facility Condition Index (FCI) System**, categorizing systems as "Good" (FCI < .25), "Fair" (FCI 0.25 – 0.50), "Poor" (FCI 0.51 – 0.85), or "Unsatisfactory" (FCI > .86).

**Comments:**

<b>1 Conveying System</b>	
<b>2 Electrical</b>	
<b>3 Exterior Finish</b>	
<b>4 Structure</b>	
<b>5 HVAC</b>	
<b>6 Interior Finish</b>	
<b>7 Plumbing</b>	
<b>8 Roof</b>	
<b>9 ADA Compliance</b>	
<b>10 Technology</b>	
<b>11 Grounds</b>	

# KRAMER MIDDLE SCHOOL

1700 Q Street, S.E., Washington, DC

## RECENT HISTORY OF MODERNIZATION

### MODERNIZATIONS

✓ Modernization Projects (VARIOUS STAGES)

### 2008 STABILIZATIONS

✓ Emergency Security Repair Work (Exterior Lighting Replacements)

✓ AC Window Units Installations & Electrical Upgrades

### 2008 SUMMER BLITZ

✓ Site Work (Concrete Masonry, Painting, Fencing)

✓ Carpentry

✓ Doors & Windows

✓ Interior Finishes - Painting/Plastering

✓ Roof Repairs/Replacement

✓ Other Work Orders

✓ Mechanical

✓ Electrical

### LEGACY PROJECTS - OTHER STABLIZATIONS

✓ Interior Renovations Various (Swing Spaces/Libraries/Asst. Supt. Offices)

◻ Planning     
 ▼ Design     
 ◆ Pre-Construction     
 ◻ In Progress     
 ✓ Completed

# KRAMER MIDDLE SCHOOL

1700 Q Street, S.E., Washington, DC



Basement

- |   |   |
|---|---|
| <span style="display: inline-block; width: 15px; height: 15px; background-color: #808080; border: 1px solid black;"></span> Administration/Health | <span style="display: inline-block; width: 15px; height: 15px; background-color: #D2691E; border: 1px solid black;"></span> Auditorium        |
| <span style="display: inline-block; width: 15px; height: 15px; background-color: #9ACD32; border: 1px solid black;"></span> Gymnasium/Cafeteria   | <span style="display: inline-block; width: 15px; height: 15px; background-color: #ADD8E6; border: 1px solid black;"></span> Other             |
| <span style="display: inline-block; width: 15px; height: 15px; background-color: #6A5ACD; border: 1px solid black;"></span> Classrooms            | <span style="display: inline-block; width: 15px; height: 15px; background-color: #FF4500; border: 1px solid black;"></span> Media Center      |
| <span style="display: inline-block; width: 15px; height: 15px; background-color: #ADD8E6; border: 1px solid black;"></span> Kindergarten          | <span style="display: inline-block; width: 15px; height: 15px; background-color: #8B4513; border: 1px solid black;"></span> Computer Lab      |
| <span style="display: inline-block; width: 15px; height: 15px; background-color: #4169E1; border: 1px solid black;"></span> Pre-K/Pre-School      | <span style="display: inline-block; width: 15px; height: 15px; background-color: #3CB371; border: 1px solid black;"></span> OT/PT             |
| <span style="display: inline-block; width: 15px; height: 15px; background-color: #CD5C5C; border: 1px solid black;"></span> Music/Art             | <span style="display: inline-block; width: 15px; height: 15px; background-color: #4169E1; border: 1px solid black;"></span> Special Education |
| <span style="display: inline-block; width: 15px; height: 15px; background-color: #2E8B57; border: 1px solid black;"></span> Science Lab           | <span style="display: inline-block; width: 15px; height: 15px; background-color: #9370DB; border: 1px solid black;"></span> Unassigned        |
| <span style="display: inline-block; width: 15px; height: 15px; background-color: #D9EAD3; border: 1px solid black;"></span> Lobby                 | <span style="display: inline-block; width: 15px; height: 15px; background-color: #9370DB; border: 1px solid black;"></span> Elevator Addition |

**Concept Plans**

These floor plans represent planning concepts for proposed facility use, aligning the proposed program capacity, the proposed planning profiles, and the conceptual reconfiguration of the building. Each project is subject to a formal design process, incorporating input from the School Improvement team at the time of project initiation.

# KRAMER MIDDLE SCHOOL

1700 Q Street, S.E., Washington, DC



First Floor

- |   |   |
|---|---|
| <span style="display: inline-block; width: 15px; height: 15px; background-color: #808080; border: 1px solid black;"></span> Administration/Health | <span style="display: inline-block; width: 15px; height: 15px; background-color: #FF8C00; border: 1px solid black;"></span> Auditorium        |
| <span style="display: inline-block; width: 15px; height: 15px; background-color: #9ACD32; border: 1px solid black;"></span> Gymnasium/Cafeteria   | <span style="display: inline-block; width: 15px; height: 15px; background-color: #ADD8E6; border: 1px solid black;"></span> Other             |
| <span style="display: inline-block; width: 15px; height: 15px; background-color: #6A5ACD; border: 1px solid black;"></span> Classrooms            | <span style="display: inline-block; width: 15px; height: 15px; background-color: #FF4500; border: 1px solid black;"></span> Media Center      |
| <span style="display: inline-block; width: 15px; height: 15px; background-color: #ADD8E6; border: 1px solid black;"></span> Kindergarten          | <span style="display: inline-block; width: 15px; height: 15px; background-color: #8B4513; border: 1px solid black;"></span> Computer Lab      |
| <span style="display: inline-block; width: 15px; height: 15px; background-color: #4169E1; border: 1px solid black;"></span> Pre-K/Pre-School      | <span style="display: inline-block; width: 15px; height: 15px; background-color: #3CB371; border: 1px solid black;"></span> OT/PT             |
| <span style="display: inline-block; width: 15px; height: 15px; background-color: #A52A2A; border: 1px solid black;"></span> Music/Art             | <span style="display: inline-block; width: 15px; height: 15px; background-color: #4169E1; border: 1px solid black;"></span> Special Education |
| <span style="display: inline-block; width: 15px; height: 15px; background-color: #2E8B57; border: 1px solid black;"></span> Science Lab           | <span style="display: inline-block; width: 15px; height: 15px; background-color: #9370DB; border: 1px solid black;"></span> Unassigned        |
| <span style="display: inline-block; width: 15px; height: 15px; background-color: #D2B48C; border: 1px solid black;"></span> Lobby                 | <span style="display: inline-block; width: 15px; height: 15px; background-color: #9370DB; border: 1px solid black;"></span> Elevator Addition |

**Concept Plans**

These floor plans represent planning concepts for proposed facility use, aligning the proposed program capacity, the proposed planning profiles, and the conceptual reconfiguration of the building. Each project is subject to a formal design process, incorporating input from the School Improvement team at the time of project initiation.

# KRAMER MIDDLE SCHOOL

1700 Q Street, S.E., Washington, DC



Second Floor

- |   |   |
|---|---|
| <span style="display: inline-block; width: 15px; height: 15px; background-color: #808080; border: 1px solid black;"></span> Administration/Health | <span style="display: inline-block; width: 15px; height: 15px; background-color: #FF8C00; border: 1px solid black;"></span> Auditorium        |
| <span style="display: inline-block; width: 15px; height: 15px; background-color: #90EE90; border: 1px solid black;"></span> Gymnasium/Cafeteria   | <span style="display: inline-block; width: 15px; height: 15px; background-color: #ADD8E6; border: 1px solid black;"></span> Other             |
| <span style="display: inline-block; width: 15px; height: 15px; background-color: #9370DB; border: 1px solid black;"></span> Classrooms            | <span style="display: inline-block; width: 15px; height: 15px; background-color: #FF4500; border: 1px solid black;"></span> Media Center      |
| <span style="display: inline-block; width: 15px; height: 15px; background-color: #E6E6FA; border: 1px solid black;"></span> Kindergarten          | <span style="display: inline-block; width: 15px; height: 15px; background-color: #A52A2A; border: 1px solid black;"></span> Computer Lab      |
| <span style="display: inline-block; width: 15px; height: 15px; background-color: #4169E1; border: 1px solid black;"></span> Pre-K/Pre-School      | <span style="display: inline-block; width: 15px; height: 15px; background-color: #3CB371; border: 1px solid black;"></span> OT/PT             |
| <span style="display: inline-block; width: 15px; height: 15px; background-color: #CD5C5C; border: 1px solid black;"></span> Music/Art             | <span style="display: inline-block; width: 15px; height: 15px; background-color: #0000FF; border: 1px solid black;"></span> Special Education |
| <span style="display: inline-block; width: 15px; height: 15px; background-color: #2E8B57; border: 1px solid black;"></span> Science Lab           | <span style="display: inline-block; width: 15px; height: 15px; background-color: #9370DB; border: 1px solid black;"></span> Unassigned        |
| <span style="display: inline-block; width: 15px; height: 15px; background-color: #D2B48C; border: 1px solid black;"></span> Lobby                 | <span style="display: inline-block; width: 15px; height: 15px; background-color: #9370DB; border: 1px solid black;"></span> Elevator Addition |

### Concept Plans

These floor plans represent planning concepts for proposed facility use, aligning the proposed program capacity, the proposed planning profiles, and the conceptual reconfiguration of the building. Each project is subject to a formal design process, incorporating input from the School Improvement team at the time of project initiation.

# KRAMER MIDDLE SCHOOL

1700 Q Street, S.E., Washington, DC

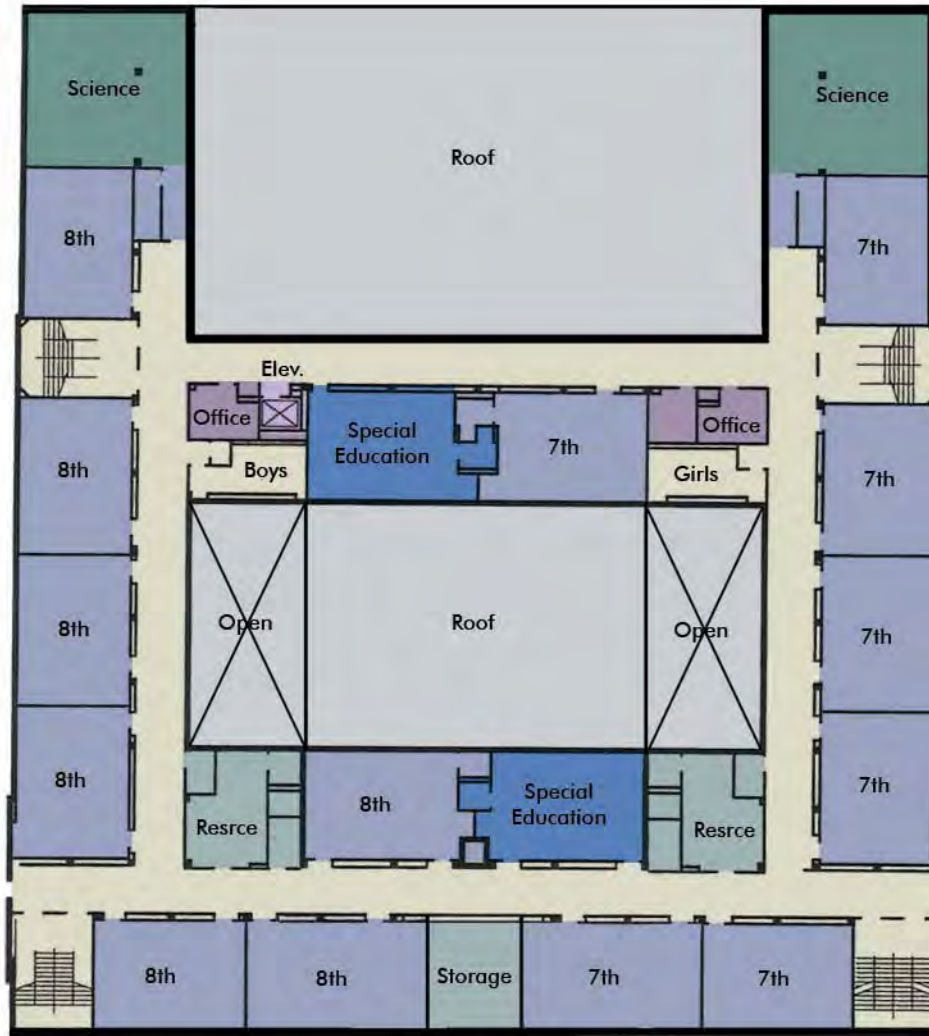

Third Floor

- |   |   |
|---|---|
| <span style="display: inline-block; width: 15px; height: 15px; background-color: #808080; border: 1px solid black;"></span> Administration/Health | <span style="display: inline-block; width: 15px; height: 15px; background-color: #FFD700; border: 1px solid black;"></span> Auditorium        |
| <span style="display: inline-block; width: 15px; height: 15px; background-color: #90EE90; border: 1px solid black;"></span> Gymnasium/Cafeteria   | <span style="display: inline-block; width: 15px; height: 15px; background-color: #ADD8E6; border: 1px solid black;"></span> Other             |
| <span style="display: inline-block; width: 15px; height: 15px; background-color: #6A5ACD; border: 1px solid black;"></span> Classrooms            | <span style="display: inline-block; width: 15px; height: 15px; background-color: #FF4500; border: 1px solid black;"></span> Media Center      |
| <span style="display: inline-block; width: 15px; height: 15px; background-color: #B0C4DE; border: 1px solid black;"></span> Kindergarten          | <span style="display: inline-block; width: 15px; height: 15px; background-color: #8B4513; border: 1px solid black;"></span> Computer Lab      |
| <span style="display: inline-block; width: 15px; height: 15px; background-color: #4169E1; border: 1px solid black;"></span> Pre-K/Pre-School      | <span style="display: inline-block; width: 15px; height: 15px; background-color: #3CB371; border: 1px solid black;"></span> OT/PT             |
| <span style="display: inline-block; width: 15px; height: 15px; background-color: #CD5C5C; border: 1px solid black;"></span> Music/Art             | <span style="display: inline-block; width: 15px; height: 15px; background-color: #4169E1; border: 1px solid black;"></span> Special Education |
| <span style="display: inline-block; width: 15px; height: 15px; background-color: #2E8B57; border: 1px solid black;"></span> Science Lab           | <span style="display: inline-block; width: 15px; height: 15px; background-color: #9370DB; border: 1px solid black;"></span> Unassigned        |
| <span style="display: inline-block; width: 15px; height: 15px; background-color: #D2B48C; border: 1px solid black;"></span> Lobby                 | <span style="display: inline-block; width: 15px; height: 15px; background-color: #9370DB; border: 1px solid black;"></span> Elevator Addition |

**Concept Plans**

These floor plans represent planning concepts for proposed facility use, aligning the proposed program capacity, the proposed planning profiles, and the conceptual reconfiguration of the building. Each project is subject to a formal design process, incorporating input from the School Improvement team at the time of project initiation.