

# *A Window of Opportunity for DC and Ward 7*

---

## *Facilities Plan Proposal for Empowering Males of Color (EMOC) High School & New Ward 7 Middle School*

### **August 2016:**

Open the EMOC specialty high school with intensive individualized support for young men and a full spectrum of course offerings for 9<sup>th</sup> graders in transitional first year space at HD Woodson.

### **August 2017:**

Open an innovative education hub as the permanent home for EMOC specialty HS and a co-location of a selective and neighborhood middle school that provides missing capacity for middle grades population living north of East Capitol Street in Ward 7.

### **Potential Benefits:**

- Time for community, school and facilities planning to secure greatest benefits to students and communities.
- Strong first year educational program for EMOC with shared space and future benefits for HD Woodson.
- Adequate design and construction time ensuring higher quality and lower costs.

### **How to make this happen:**

October 2015	<b>Amend RFP to include planning deliverables and feasibility studies</b>
	<b>Prepare plans with educators, students, parents and other community</b>
November 2015 to February 2016	<ul style="list-style-type: none"><li>✓ Space plan to support EMOC transition at Woodson</li><li>✓ Revisions to boilerplate EMOC ed spec to fully reflect EMOC unique program and supports</li><li>✓ Ed Spec for specialty and neighborhood MS for Ward 7</li></ul>
February 2016 to March 2016	<b>Feasibility studies</b> <ul style="list-style-type: none"><li>✓ Schematic design options for EMOC and MS</li><li>✓ Preliminary construction schedule</li><li>✓ Independent cost estimates</li></ul>
March 25 2016	<b>Formal recommendations and decisions on options and estimates in feasibility studies</b>
June 2016 to June 2017	<b>Design development and construction</b>

# Use Ron Brown Campus for EMOC HS AND New MS

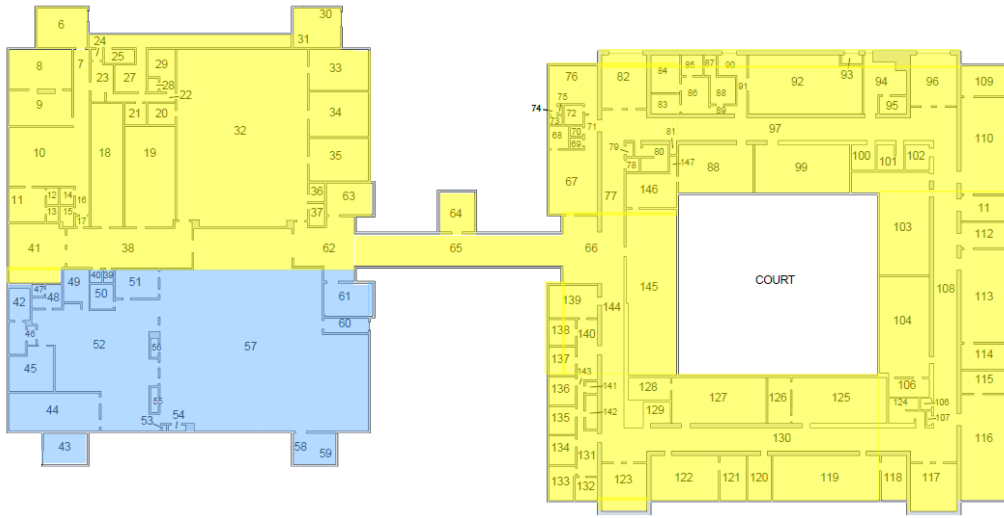

**1<sup>st</sup> Floor: 65,514 GSF**

**340 student MS**  
66,010 GSF Total (with shared space)

EMOC HS:  
14,423 GSF 1<sup>st</sup> Floor



**2<sup>nd</sup> Floor: 65,336 GSF**

**400 student EMOC HS**

Shared Space:  
15,919 GSF

EMOC HS:  
49,417 GSF



**3<sup>rd</sup> Floor: 43,255 GSF**

Total EMOC HS:  
123,014 GSF  
(Includes shared space)

*Data Source: 4tell Solutions, DCPS space analysis May 2013; plan option by 21CSF*

## Use Excess Capacity at Woodson for EMOC Transition



### H.D. Woodson HS Enrollment Capacity compared to 2014-15 Enrollment

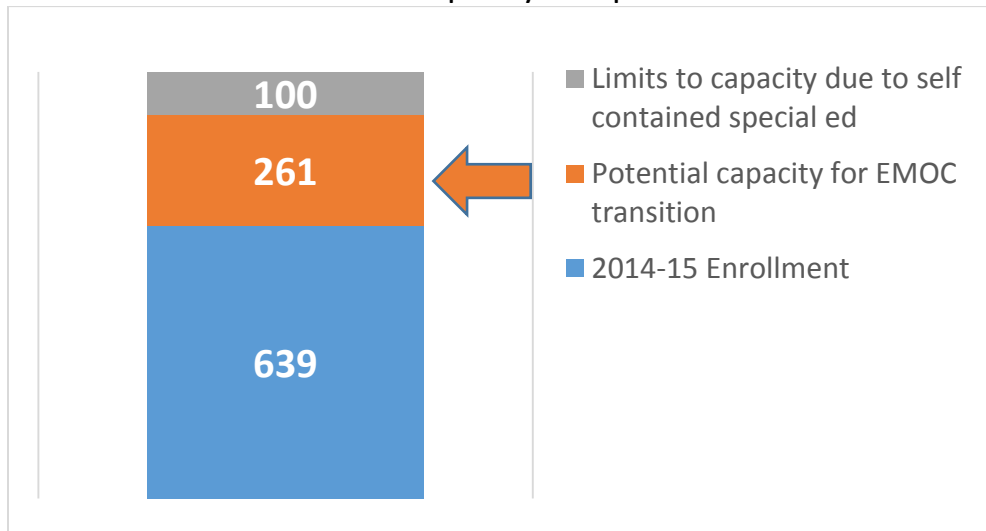

#### Benefits:

- Outreach for EMOC to families and students can begin now, because risk associated with facilities uncertainties are eliminated.
- Ninth grade EMOC HS and HD Woodson can share staff and/or classes in world languages, art, music and physical education to their mutual benefit.
- Woodson can plan an academy to open in August 2017 in the space vacated by EMOC when they move to the permanent Ron Brown location.

# Increase Equity in Ward 7 via Access to New Middle School

Over 500 11 to 13 year olds living in Kelly Miller’s boundary  
**MUST** travel outside their neighborhood to attend middle school

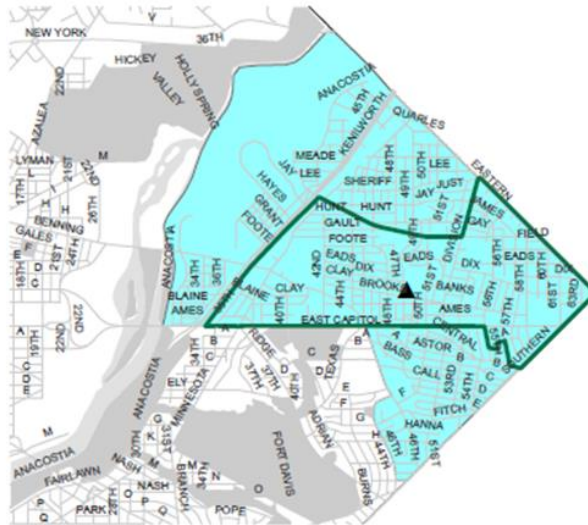

*KELLY MILLER New BOUNDARY MAP August 2014,  
 Student Assignment Initiative, Office of the Deputy Mayor for Education (old boundary shown in green)*

## Projected Population of 11 to 13 year olds (2017) compared to Public School Seats in the Kelly Miller Boundary (2016-17)

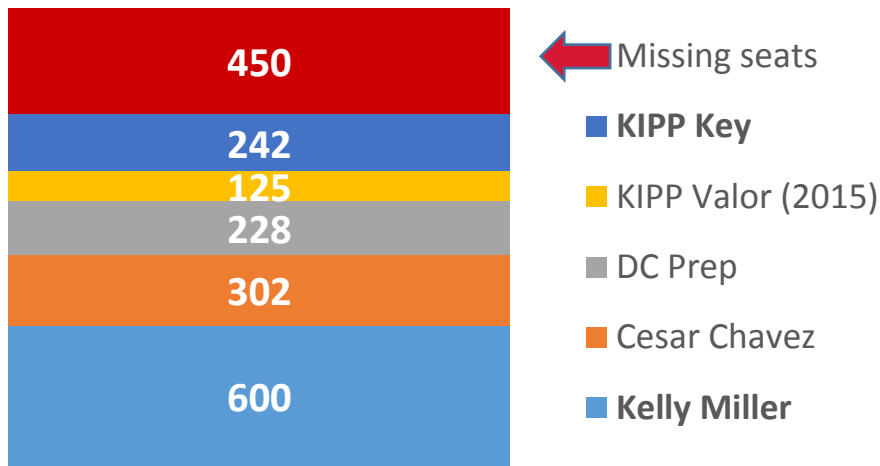

- Full utilization of prime space at Ron Brown for middle school, as well as specialty HS.
- Potential for by right access to high quality new middle school closer to home for 11 to 13 year olds from Houston and Thomas.
- Potential for selective middle school academy at new middle school.
- Eliminate crowding at Kelly Miller MS, and the need for portable classrooms.